

FINGERPRINT DOOR LOCK

M800

Product Guide

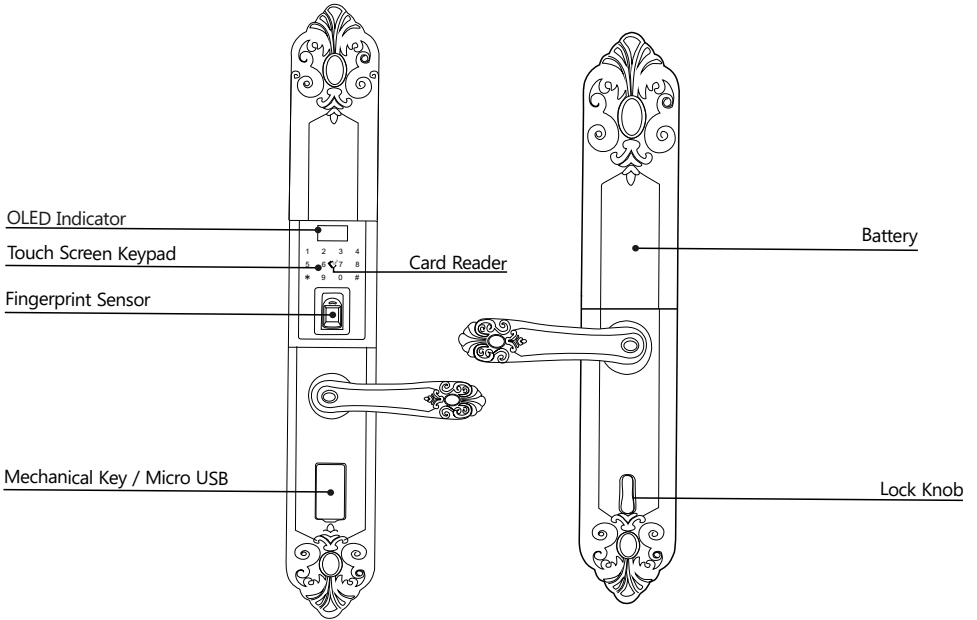

Brief Introduction

- 1 There are up to 300 users available in the lock, which can be divided into 2 types:
a) Master User: ID from 001 to 009;
b) Normal User: ID from 010 to 300;
- 2 The password can be set with 6 to 10 digits. In factory default, the master password is 123-456;
- 3 There are single unlocking mode and double unlocking mode in the lock. Single unlocking mode is default.
- 4 There is voice introduction to help you understand the operations in the lock.
- 5 The lock will be locked for 5 minutes after inputting wrong password in 3 times.
- 6 When the battery voltage is low than 4.8V, the low battery alarm will be activated every time when unlock the lock.
- 7 The cylinder and the Micro USB port are in the cylinder position, take out the cylinder cover and you will find them.
- 8 The Security bolt has to be unlocked from inside.

Operation

1 Some Suggestions to Help Capturing the Fingerprint

When placing the finger on the sensor, please make sure the “core” of fingerprint is staying in the main area of sensor directly with a little be pressure. Like the pictures show as following:

Insert Image

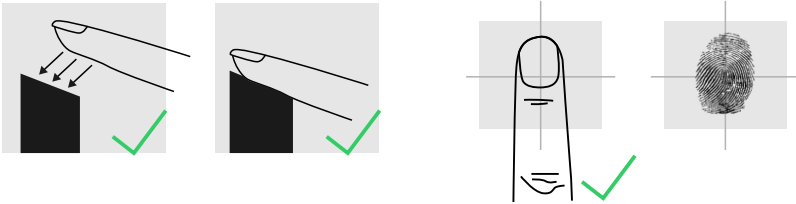

The sensor may not capture the correct fingerprint image if you take the following operations.

Insert Image

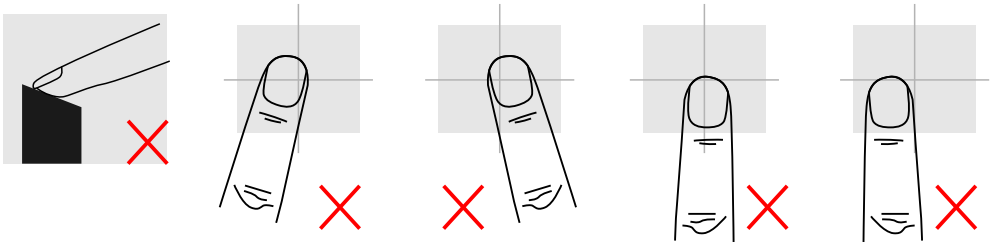

 **it is suggested to register the thumb, first finger, and middle finger for better fingerprint images.**

2 Fingerprint Unlocking

Place the finger on the sensor, the lock will be activated automatically and started to capture the fingerprint image for identification. Once the identification is passed, the LCD shows the unlock information with sounds, then you can press down the handle for unlocking.

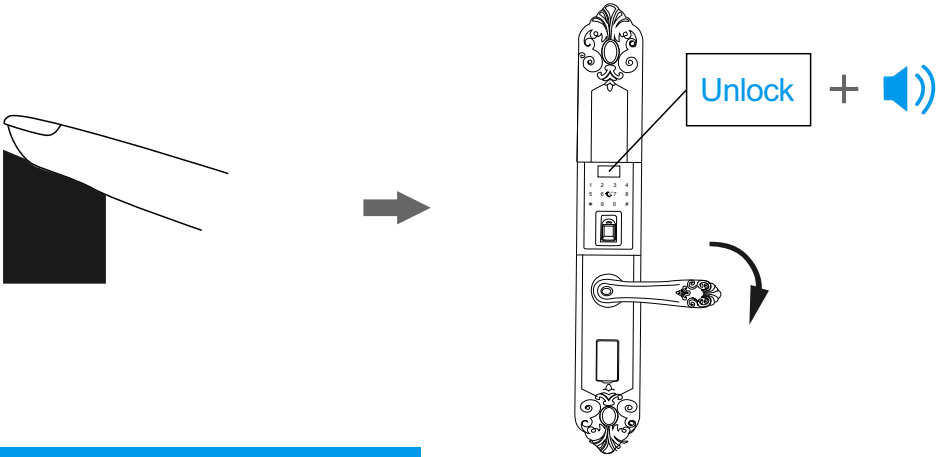

3 Password Unlocking

Touch the keypad to activate the lock, and then input the password (6-10 digits) with pressing “#” to finish. If the password is correct, the LCD shows the unlock information with sounds, then you can press down the handle for unlocking.

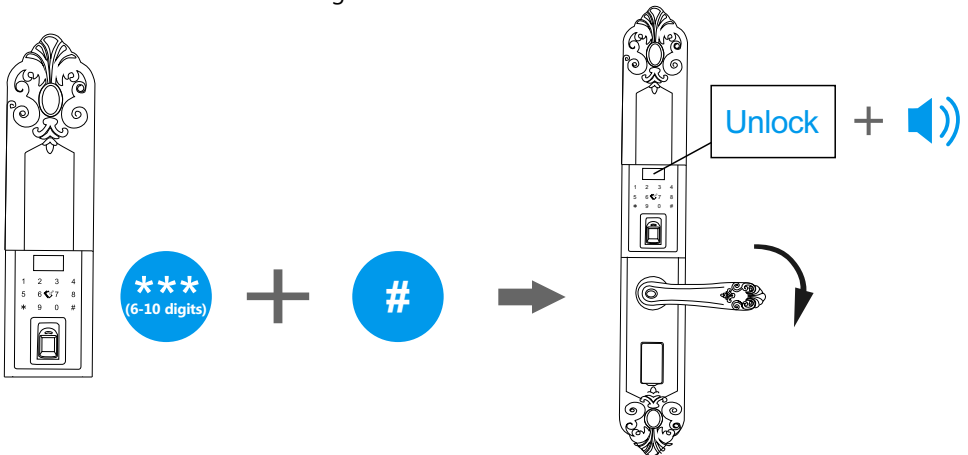

When inputting a wrong password for 3 times, the lock will be locked for 5 minutes. During the 5 minutes, the lock cannot be activated and all operations are not available. After that, the lock returns to normal state.

Random Password Protection

For a better security protection to the password user, the lock is designed with a random password protection. You can add any digits before and after the real password.

For example, the password is "1234-5678", you can unlock the lock by inputting the password as following:

1: 1 2 3 4 5 6 7 8 X X X X X #

2: X X X X X X 1 2 3 4 5 6 7 8 #

3: X X X X 1 2 3 4 5 6 7 8 X X X X #

4 RF Card Unlocking

Place the card close to the card reader to verify, if the card is correct, the LCD shows the unlock information with sounds, then you can press down the handle for unlocking.

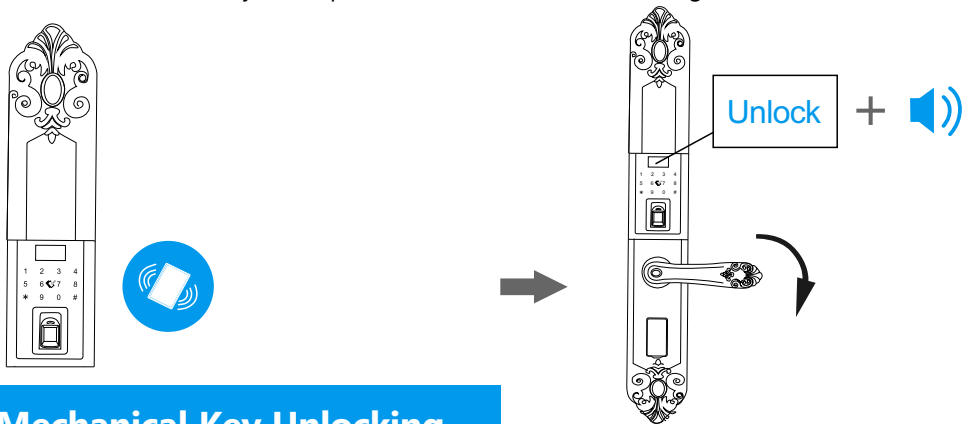

5 Mechanical Key Unlocking

When there is problem with electronic part, and the batteries run out of power, using mechanical key is the way to unlock the lock.

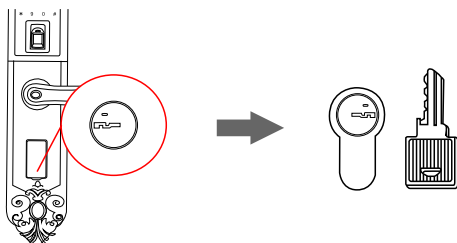

Operation

1 Register Master User

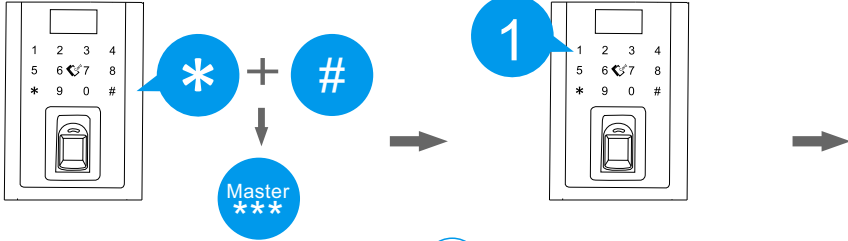

a Press * and then press #, and then input the master password to log in the system;

b Select 1 for master user setting;

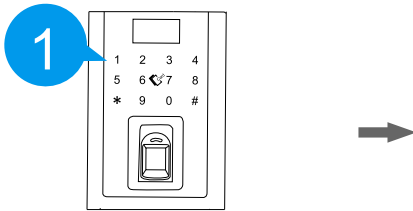

c Select 1 to add new user;

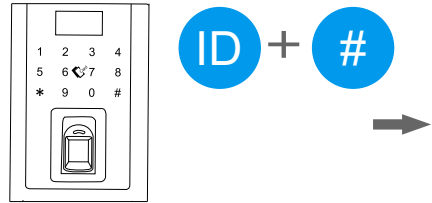





d Input the ID number for the user (ID from 001 to 009), then press # to confirm;



e Fingerprint User: place the finger on the sensor in 2 times to register;

e Password User: input the password in 2 times to register;

e Card User: place the card on the reader to register;

-  **1. The default master password is 123-456;**
-  **2. There are maximum 9 master users are available in the lock;**
-  **3. Please try to use the master user to unlocking to make sure the operations are successful.**
-  **4. The password can be set 6 to 10 digits;**

2 Register Normal User

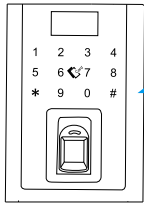

- a Press * and then press #, and then input the master password to log in the system;

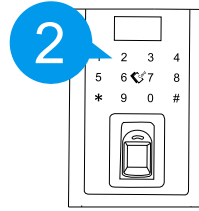

- b Select 2 for normal user setting;

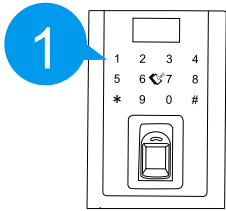

- c Select 1 to add new user;

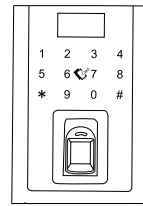

- d Input the ID number for the user (ID from 010 to 300), then press # to confirm;



- e Fingerprint User: place the finger on the sensor in 2 times to register;



- e Password User: input the password in 2 times to register;



- e Card User: place the card on the reader to register;

 **Please try to use the registered user to unlock and make sure the operations are successful.**

3 Modify Master User

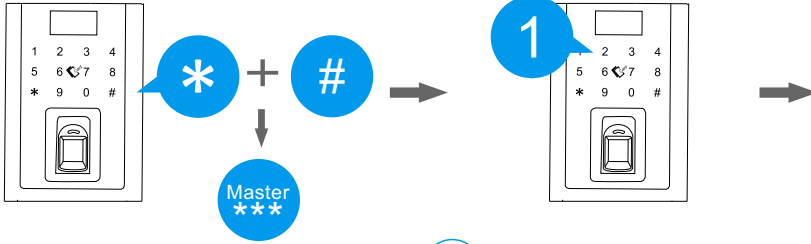

a Press * and then press #, and then input the master password to log in the system;

b Select 1 for master user setting;

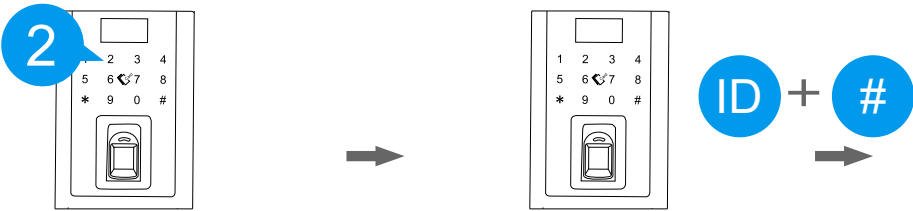

c Select 2 to modify the user information;

d Input the ID number you want to modify, then press # to confirm;



e Fingerprint User: place the finger on the sensor in 2 times to register;

e Password User: input the password in 2 times to register;

e Card User: place the card on the reader to register;

⚠ 1. Modify the users mean to change the unlocking method or password for the users;

⚠ 2. Please try to use the modified user to unlock and make sure the operations are successful.

4 Modify Normal User

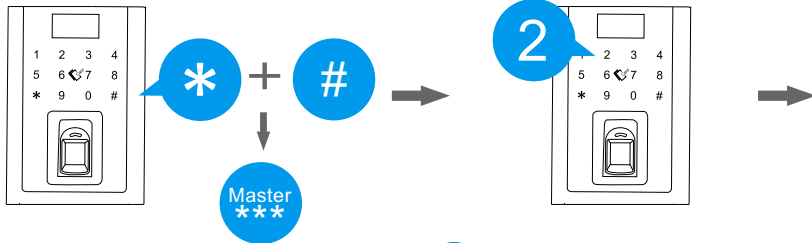

- a Press * and then press #, and then input the master password to log in the system;

- b Select 2 for normal user setting;

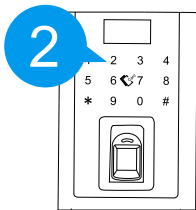

- c Select 2 to modify the user information;

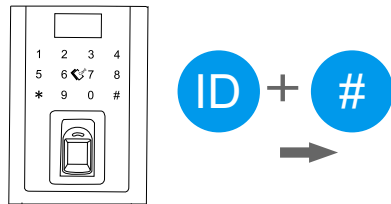

- d Input the ID number you want to modify, then press # to confirm;



- e Fingerprint User: place the finger on the sensor in 2 times to register;



- e Password User: input the password in 2 times to register;



- e Card User: place the card on the reader to register;

⚠ 1. Modify the users mean to change the unlocking method or password for the users;

⚠ 2. Please try to use the modified user to unlock and make sure the operations are successful.

5 Delete Master User

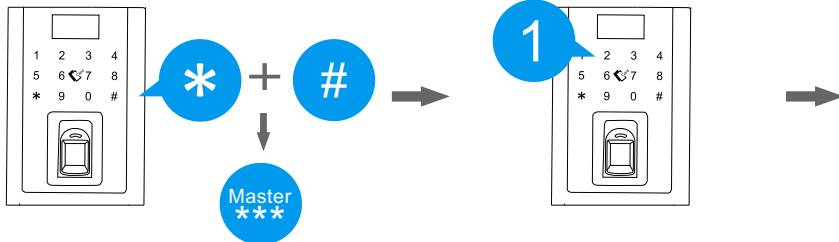

- (a) Press * and then press #, and then input the master password to log in the system;

- (b) Select 1 for master user setting;

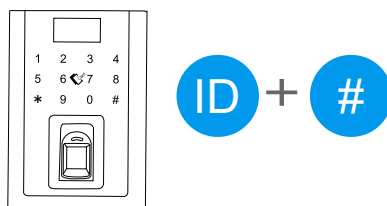
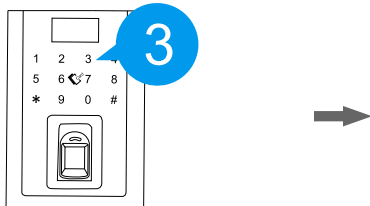

- (c) Select 3 to delete the user information;

- (d) Input the ID number you want to delete, then press # to confirm;

 **Please try to use the deleted user to unlock and make sure the operations are successful.**

6 Delete Normal User

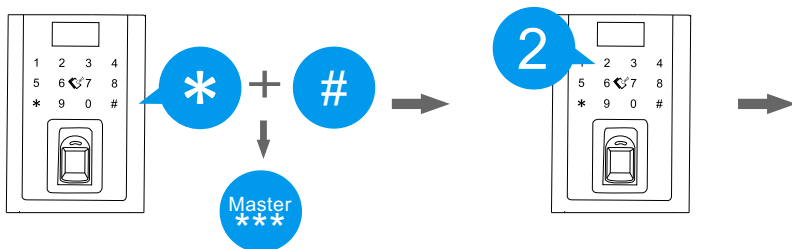

- (a) Press * and then press #, and then input the master password to log in the system;

- (b) Select 2 for normal user setting;

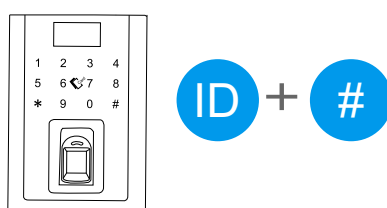
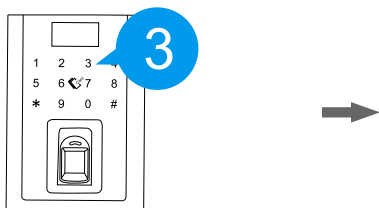

- (c) Select 3 to delete the user information;

- (d) Input the ID number you want to delete, then press # to confirm;

 **Please try to use the deleted user to unlock and make sure the operations are successful.**

7 Double Unlocking Mode

For better security, you can set up the lock to double unlocking mode. When the lock is under double unlocking mode, you have to input 2 registered users every time for unlocking.

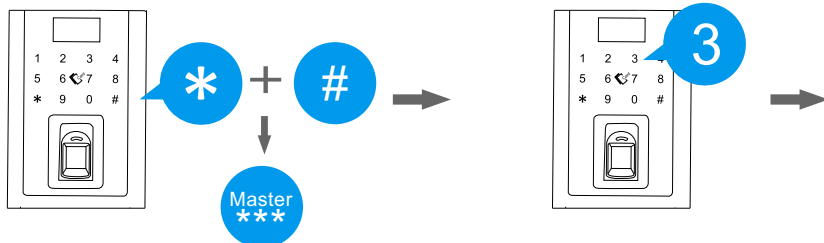

- a** Press * and then press #, and then input the master password to log in the system;

- b** Select 3 for system setting;

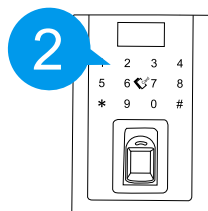
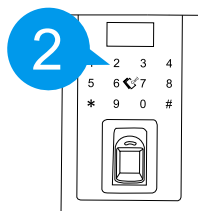

- c** Select 2 for unlocking mode;

- d** Select 2 for double unlocking mode; (1 is for single unlocking mode)

! 1. During the lock is under double unlocking mode, you have to input 2 registered users every time to unlock.

! 2. If you want to switch to single unlocking mode, please follow the operations above, and then select 1 for single unlocking mode at the last.

8 Date and Time Setting

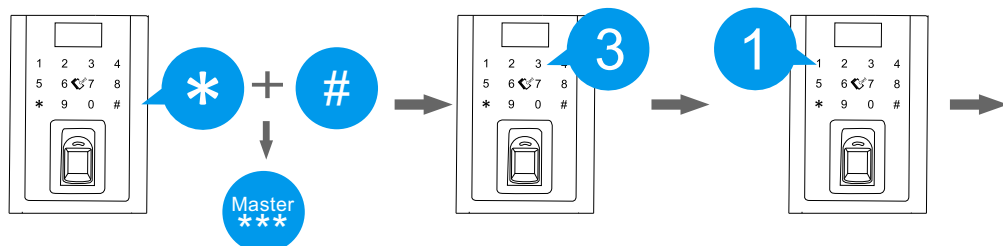

- a** Press * and then press #, and then input the master password to log in the system;

- b** Select 3 for system setting;

- c** Select 1 for date and time setting;

XX-XX-XXXX
XX:XX:XX

- d** Input the correct date and time for the lock;

9 Passage Mode

When the lock is required to unlock frequently, set the lock to passage mode can let the people unlock the lock without any identification.

Enable:

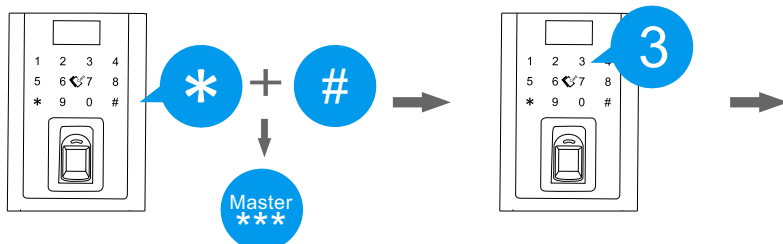

- a Press * and then press #, and then input the master password to log in the system;

- b Select 3 for system setting;

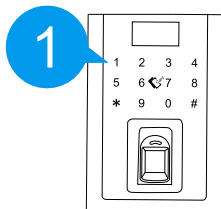
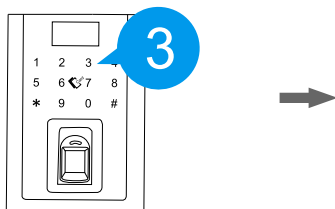

- c Select 3 for passage mode;

- d Select 1 to enable the passage mode;

Disable:

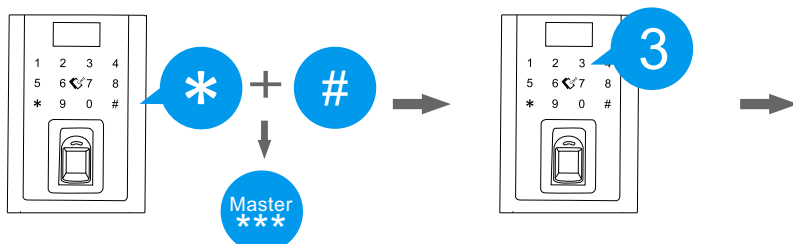

- a Press * and then press #, and then input the master password to log in the system;

- b Select 3 for system setting;

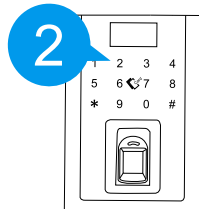
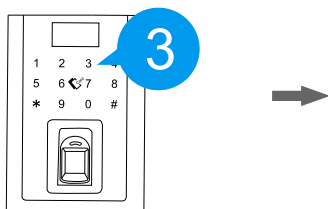

- c Select 3 for passage mode;

- d Select 2 to disable the passage mode;

10 Unlock Record

The lock can keep up to 6,000 the latest unlock records, which you can track the access from the LCD.

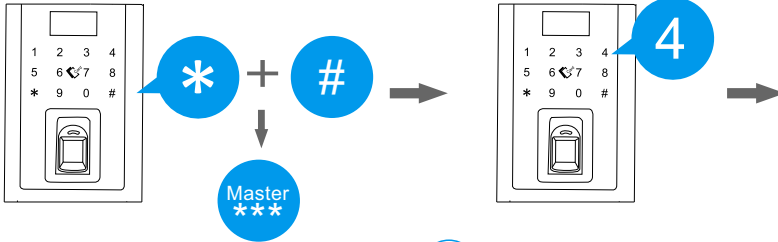

- a Press * and then press #, and then input the master password to log in the system;

- b Select 4 for unlock record;

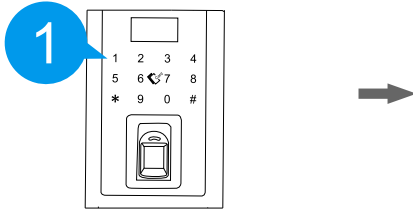

- c Select 1 for checking the records;

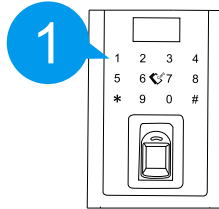

- d Select 1 to check the unlock records.

11 Restore to Factory Default

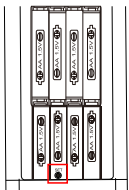

Restore begins

- a Press and hold the "SET" key in the battery case for some time;

- b Release the key when the LCD display shows the restore begins.

⚠️ 1. When the lock is reset to factory default, any fingerprint and password can unlock;

⚠️ 2. The master password will be reset to "123-456".